



OUR STORY

Our mission is to cultivate a community passionate about preserving our agricultural heritage, educating and feeding our neighbors, and growing a sustainable future.

PROGRAMS:

- Little Farmers (3-5 years old)
- Farm Kids Club (5 years old & up)
- Heritage Homeschool (5-18 years old)
- Summer Camps (5-18 years old)
- Power of Produce (1-12 years old)
- Veteran & Beginning Farmer Series
- Living Landscapes (Adults)
- Heritage Skills (Adults)

HISTORY

1990's As a result of two visionaries who desired to preserve the agricultural heritage of Cullman County, the Alabama Agriculture Museum and Hall of Fame began

2000 The North Alabama Agriplex board was established under Senate Bill 323

2013 Agriplex Heritage Center opened

2014-2020 Food for Life AmeriCorps Grant

2020 Corner property purchased for expansion

2022 Kickoff Home for the Harvest Capital Campaign

2025 Groundbreaking and Construction of Community Hub

OUR PLANS

To better serve our community, we are expanding our campus which will feature a 8,505 square foot community hub, teaching kitchen and administrative areas shared with the Cullman County Extension office.

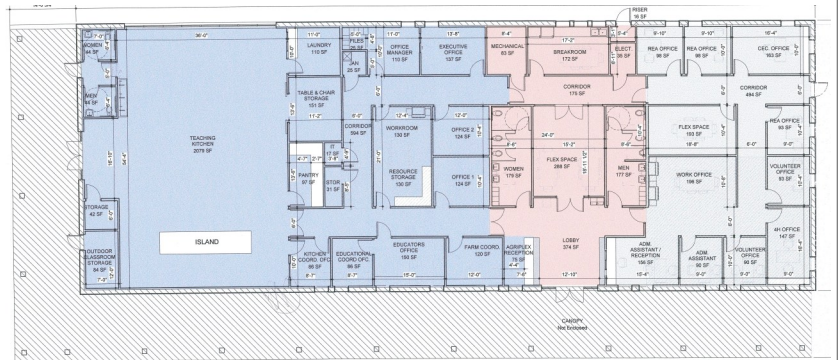

OUR LEADERS



Rachel Dawsey
Executive Director

As director, Rachel oversees 9 staff members working with schools, communities, organizations, and local businesses. In 2024, the Agriplex had over 25,000 participants including from 23 schools. Already in 2025, we have served over 30 counties.



Mike Roden
Board President

Board Members

Mike Roden
Bonnie Baty
Billy Troutman
Paul Pinyan
Lee Haynes
Joann Minnett
Greg Anderson
Suzanne Wood
Amelia Mitchell
Will Bonds
Tyler Monday



Amanda Stanton
Foundation President

Foundation Board Members

Amanda Stanton
Matt Kinsland
Audrey Crabb
Rachel Dawsey
Tom Williamson
Suzanne Rollo
Richard Crabb
Stefani Nelson



WHY

Community Impact

- Create a gathering space to foster social connections and a sense of community
- Teach garden to table skills classes to develop lifelong, sustainable living habits for all ages
- Improves the local communities health and well being through nutrition education
- Creates a lasting legacy of healthier eating habits for future generation
- Provide workforce development in agriculture and food services

WHAT

Expanded space to allow more opportunities for our community

Modern Demonstration/Teaching Kitchen
Cullman County Extension Office Wing
Multiuse Classroom
Multipurpose Breezeway
North Alabama Agriplex Office Wing



HOW

A capital campaign to raise 3.2 million by 2025

Level of Tiered Giving	Gift Amount	Gifts Needed	Total
Harvesters	\$100,000	3	\$300,000
Cultivators	\$50,000	6	\$300,000
Growers	\$25,000	6	\$150,000
Sowers	\$10,000	10	\$100,000
Seeds	\$5,000	15	\$75,000
Roots	\$1,000	75	\$75,000

WAYS TO GIVE

In Person

PO Box 2428
Cullman, AL 35056



Scan to donate